

Conill Advertising

El Segundo, CA

As a tenant improvement project for latin-based advertising agency Conill, the design is composed of folding geometries, vibrant colors, and a marketing concept for “places” throughout the office.



LOCATION:
El Segundo, CA

TAGS:

- ADAPTIVE REUSE
- CUSTOM FABRICATION
- OFFICE
- SOCIAL & MEETING PLACE
- WORKPLACE

Shubin Donaldson

The arrival into the space — as is typical with most offices of this size — begins at the centrally-located elevator core filtering into the main reception area. This space serves as the nucleus of the office providing two arteries leading into either the executive offices/conference rooms or into the main workstations. Using faceted walls and undulating fins, the design creates dynamic circulation throughout which lead into different “places” each possessing unique identities and opportunities for collaboration. These “places” include “the club” — the primary break out space containing a fully-equipped bar, kitchen, ping pong table, and seating; “the park” — a playful break out space adjacent to the workstations integrating monkey bars, whiteboards, terrariums, and fun lounge seating resembling large rocks; and “the beach” — an outdoor terrace with synthetic grass and patio seating spaces for the employees to get some fresh air. In short, the design for Conill created a fun, energetic environment for the young advertising agency to get the creative juices flowing and provide the resources needed for collaboration and innovation to thrive.

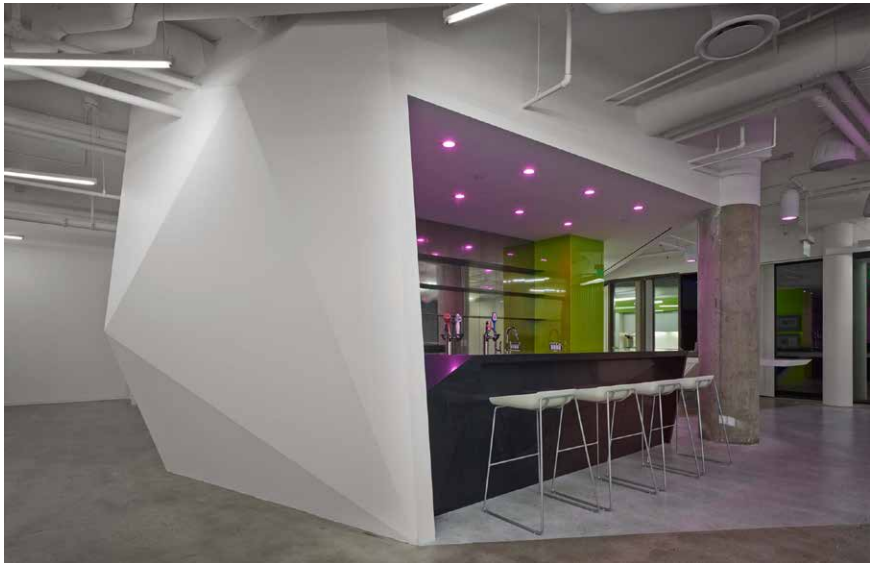
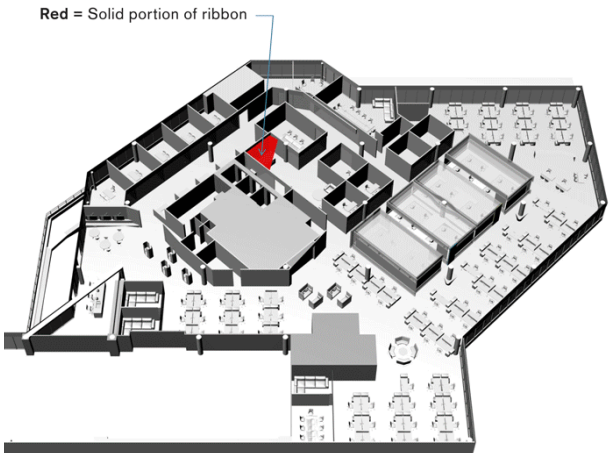

ShubinDonaldson

Project Information

PARTNERS IN CHARGE:
Russell Shubin, AIA, LEED AP
Robin Donaldson, AIA

PROJECT TEAM:
Andrew Alcalá
Geo Chevez
Marty Schibler
Irene Acosta

CONTRACTOR:
Sierra Pacific Constructors

PHOTOGRAPHER:
Benny Chan

